

# SPC Rigid Flooring Installation Guide



## Note.

The following instructions are intended to assist in achieving an optimum installation. Any variation to these instructions by installers may affect the BIFORM warranties.

BiForm Premium SPC Rigid Flooring must be installed using a floating floor system. Warning - Floating floor installation systems should NOT be used if loads are likely to exceed 200kg/object area or if the load is greater than 30kg/cm<sup>2</sup> - only direct stick products should be considered.

## Safety Equipment.

It is the installer's responsibility to verify that the product and accessories supplied is the correct product, colour, pattern and quantity. Prior to installation, each plank should be carefully checked in good natural light for any obvious visual defects. Never install defective product (unless agreed by a BIFORM representative). If the product is incorrect or has any visual defects or damage, contact the retailer or BIFORM representative.

Generally, BIFORM will not be responsible for any visible defects after the flooring has been cut and/or installed.

## Site Testing and Conditioning.

Concrete subfloors must be cured for 60 days prior to installation of the flooring and should be tested for excessive moisture.

Generally, BiForm Premium SPC Rigid Flooring planks do not need to be acclimatised. However, if boxes are exposed to extreme temperatures within the 12 hours prior to installation please refer to the Extreme Temperatures note at the end of these instructions.

## Prior to Installation.

Cartons should always be stored horizontally. Protect carton corners from damage. During installation, inspect the groove area and remove any debris that may prevent proper assembly of planks/ tiles.

## Sub Floor Preparation.

Subfloors must be level, smooth, dry and free of any surface irregularities including dust, dirt, oil, grease, paint or other materials or roughness.

Concrete floors must be cured, completely dry, with a surface free of irregularities. When a straight edge 2 metres long is placed at rest at 2 points 2 metres apart, no part of the surface shall be more than 3mm below the length of the straightedge.

Depressions and cracks must be filled using a suitable (taking into account the traffic loads) approved levelling compound in accordance with the manufacturer's instructions. All irregularities must be levelled.

Existing timber, plywood and particleboard subfloors, must be checked for any loose boards/ panels or excessive deflection or movement. If loose boards are found or movement is excessive, the subfloor should be re-affixed and damaged boards replaced, then if required, sanded to a level, smooth and dust free surface.

The floor can be installed over most existing floorcovering (e.g. ceramic tiles, linoleum, PVC etc.) provided the floor is flat, dry and in the case of ceramics in a residential installation, grout line tolerances are no more than 3mm wide and 3mm deep. Otherwise grout joints should be filled to the level of the tiles with a suitable leveller. Carpet, carpet underlay and/ or existing floating floors is not a suitable subfloor.

BiForm Premium SPC Rigid Floors should never be installed over any electrical radiant heating system - the speed of sudden temperature changes having the potential to negatively affect the floor.

# SPC Rigid Flooring Installation Guide



## Site Testing and Conditioning.

A standard perimeter expansion gap of greater than 5mm must be maintained against all fixed vertical surfaces (e.g. walls, cabinets, sliding doors, island benches, plumbing etc.). For installation over large areas or in between multiple rooms that exceed 10m in length or 15m in width, leave not less than a 10mm expansion gap. A trim or scotia can be used to cover this gap, ensuring the floor is not pinned to the substrate or vertical surfaces. Silicone or caulking compound is not recommended.

NOTE: For installations that include the floor passing through multiple pinch-points, for example doorways and transitional areas from smaller passageways to larger rooms, consideration should be given to additional expansion allowance at these points.

## Tools and Supplies Required.

- Spacers
- Saw/ Guillotine/ Utility Knife
- Rubber Mallet
- Ruler
- Pencil
- Tape Measure

## Installation Instructions

Note: As a floating floor, the floor should not be adhered, nailed or pinned in any way to the subfloor or structure. Additional foam or cork underlays should never be used.

1. Prepare the subfloor in accordance with local building codes and as set out in this guide.

WARNING - Asbestos: Prior to any take-up or removal of floor coverings, adhesives or underlay, you should be certain these do not contain asbestos. If it is known or suspected the previous flooring, adhesive, or underlay contains asbestos, you should avoid creating dust. The previous flooring and/ or components should only be removed by an appropriately licenced asbestos removal contractor.

2. Plan the direction of the area to be installed to maximise the visual appearance once installed. The direction of the tile/plank grain should be confirmed, and the installation should be balanced from the centre of the area to minimise waste. The first row should be cut so that the first and last rows are similar in width.
3. Measure the room and estimate the number of rows required. If the last row is not at least 50mm wide, the first row should be cut so that the first and last rows are similar in width.
4. To minimise shade variation, mix and install products from several packs alternately. After laying a small quantity of product, view from a distance that allows you to clearly see the overall effect. If there is any doubt, cease installation immediately and contact your retailer or BiForm Flooring representative.

## Wet Areas.

Although BIFORM Premium SPC Rigid Floors are waterproof, it should not be used as a moisture barrier, and should not be installed in areas that have a continual risk of excessive moisture/ flooding such as saunas or outdoor areas. If being installed in a wet area (e.g. bathroom, laundry etc) please refer to the Wet Area Installation note at the end of these instructions.

## Safety Equipment.

For installations where hydronic underfloor heating is used, the surface temperature must not exceed 27°C or have any floor coverings upon it to fluctuate above this. Refer to NZ/ AS 1884-2013 4.1.3 for scope for preparing and conditioning the sub floor pre and post installation.

After installing the BiForm Premium SPC Floor the radiant heat should be applied in a gradual manner (no more than 2°C per day). Refer to the hydronic underfloor radiant heat system's manufacturer recommendations for additional guidance.

# SPC Rigid Flooring Installation Guide

## Installation Instructions (Continued).

- From the left corner of the room put the first plank in place so both the end and side seam grooves are facing outwards, using spacer blocks against the walls to maintain the appropriate expansion gap. Planks are to be installed from left to right. To assist in laying the first row straight, the use of masking tape across each short end locking system is recommended. Continue this for the first two rows and remove after completion of installation.

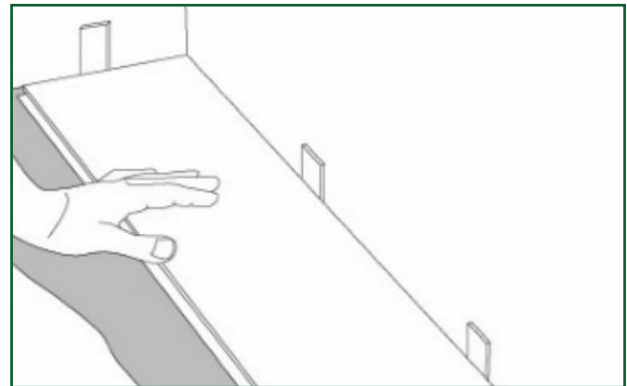

- Install the second plank in the first row by engaging the tongue of the new plank into the indent of the previously installed plank at a 30-degree angle. Lock the planks together by lowering the new plank down, ensuring the joint is fitted tightly. There should be no gaps between the planks. Care must be taken to properly line up the end joint, and never force the joint while out of alignment as this could result in permanent damage to the end groove.
- Continue in this manner for the rest of the first row. The last plank in the row should be cut to length, while still maintaining the appropriate expansion gap along the perimeter of the room or fixed vertical surfaces.

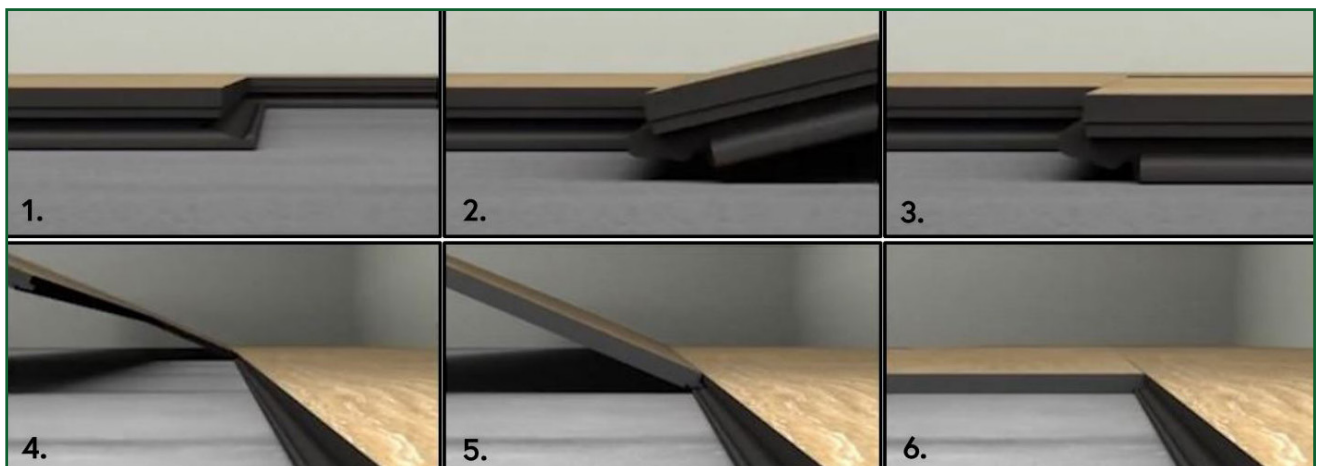

- Cut a plank that is at least 200mm shorter than the first plank to start the second row or use the cut off from the previous row, keeping in mind the length requirements. Install the first plank in the second row by inserting the long side tongue into the groove of the plank in the first row at a 30-degree angle to the installed plank. Then lower the plank while maintaining a slight pressure toward the installed plank. The planks should fit snug together and lay flat, maintaining the appropriate expansion gap along the perimeter of the room or fixed vertical surfaces.
- To install the remaining planks in the second row, first position the board at a 30-degree angle to the previous board, leaving a 20mm gap from the previous row of boards. Slide the plank to the left until it meets the previously installed plank, and the short edge tongue fits tightly into the existing boards indent.

# SPC Rigid Flooring Installation Guide

## Installation Instructions (Continued).

10. Lower the plank while maintaining a slight pressure towards the installed piece. The planks should fit snug together and lay flat. Then raise the planks in the row so they are at a 30-degree angle to the previous row of planks with the tongues fitted tightly into the long edge indents of the previous row. Lastly, lower the row of planks down so that the joints on the short and long edges are engaged. Planks should lay flat with no gaps between the previous row or installed plank.
11. Work across the length of the room installing planks in the second row. It is critical to keep these first two rows straight and square, as they are the "foundation" for the rest of the installation. Check often for squareness and straightness while installing the floor as failure to do so can result in gapping.
12. Continue installing, being certain to maintain a random pattern repeat, assisted by offsetting end joins by at least 150mm. Maintain the appropriate expansion gap against all fixed vertical surfaces.
13. Check to be certain all planks are fully engaged; if slight gapping is noticed or the planks will not lay flat, simply disengage the long/top side join and then carefully slide the short/end join apart. Do not pull up on this join as it will damage the locking mechanism. Then reinstall the plank.
14. The last row plank width should be no less than 50mm on the long seam. Remember to allow for the appropriate expansion gap to the wall.
15. Holes for pipes: measure the diameter of the pipe and drill a hole that is 20mm larger.
16. Install wall mouldings and door transition mouldings last. Be sure that all mouldings are fastened directly to the wall or subfloor; do not place any fasteners through the floating flooring. Care must be taken when fitting wall mouldings that they do not push down on the floor. This will affect the floor's ability to expand and contract and may lead to product failure.

Note: If necessary, to disassemble your BiForm Premium SPC Rigid Flooring, separate the whole row by lifting it up carefully at an angle. To separate the planks, angle planks at 30 degrees to the previous row and slide them apart.

## Installation Illustrations.

1. Start by positioning the plank at a 30-degree angle from the existing floorboard. Leave a 20mm gap from boards in the previous row.
2. Slide the angled plank into an existing board (left), ensuring the tongue is fitted tightly into the indent of the existing board.

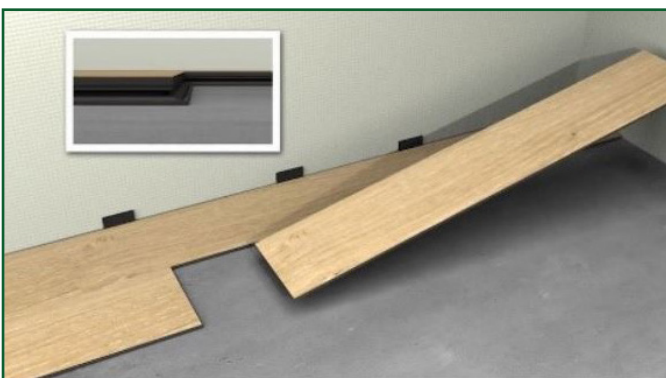

# SPC Rigid Flooring Installation Guide

## Installation Illustrations Continued.

3. Lower the new board down gently so it is parallel with existing planks and securely engaged.

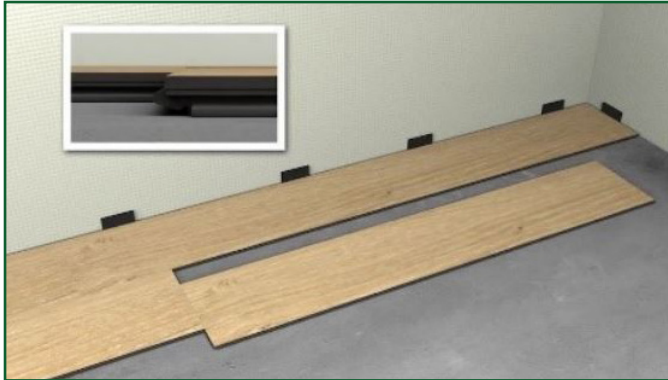

4. Position new and existing planks in the row at a 30-degree angle from the previous row of boards.



5. Gently slide the new plank down so that the tongue of the new board is engaged tightly into the indent of the existing plank in the previous row.



6. Lastly, lower all planks down. There should be no gaps between planks.



## How to Disengage.

1. Always start by disengaging the long side.
2. Grab the planks with both hands and gently lift it up until the planks disengage from the previous row.
3. To disengage the on the short side, angle the right planks upwards until they separate.

## Post Installation.

If construction works are still underway, the floor should be protected from site debris, dirt, solid, traffic etc. by use of a protective surface (e.g. sheet plastic, hard boards etc).

Please be careful to ensure no condensation occurs and any adhesive tape or protective material does not affect the aesthetics of the finished installation.

# SPC Rigid Flooring Installation Guide



## Wet Area Installations.

If your BiForm Premium SPC Rigid Flooring is being installed in a wet area.

1. If a floor waste is installed in the area and it is intended to grade the floor to the waste, the sub-floor must be prepared within the tolerances set out in the Sub Floor Preparation notes above as BiForm premium SPC Rigid Flooring, due to its rigidity, cannot be manipulated to provide any fall to waste or accommodate variations in flatness of the floor greater than those tolerances. Otherwise an alternative product should be sought.

Following the instructions set out in the Installation Procedure above;

2. Separate/isolate the wet area from the balance of the floor/area with a 3 in 1 trim or similar at the doorway or other adjoining areas.
3. Seal the perimeter of the floor using a bathroom grade silicone to prevent moisture seeping under the floor. Do not allow water to pool on the floor for long periods of time. Wet towels or bath mats should never be left on the floor to dry.

## Additional Information

Follow the BiForm Flooring Care and Maintenance instructions to properly care for your flooring. These can be found on our website at [www.BiForm.co.nz](http://www.BiForm.co.nz) or you may contact your BiForm Flooring retailer.

Please visit our website at [www.BiForm.co.nz](http://www.BiForm.co.nz) for the most up-to-date version of this document as it may have been revised and updated since this printed version.

Warranty as well as Care and Maintenance instructions can also be found on our website at [www.BiForm.co.nz](http://www.BiForm.co.nz), or you may contact your retailer.

### DISCLAIMER:

*The Diagrams and instructions in this installation guide are for illustration purposes only and are not meant or implied to replace a licensed professional. Any construction or use of BiForm Flooring products must be in accordance with New Zealand Building Code. The consumer assumes all risks and liability associated with the construction and use of the product.*

